

**Drain:** PEARLE BROOK DRAIN **Drain #:** 191  
**Improvement/Arm:** PEARLE BROOK - SECTION 3  
**Operator:** JDH **Date:** 2-26-04  
**Drain Classification:** Urban/Rural **Year Installed:** ~~1994~~ 1986

### GIS Drain Input Checklist

- Pull Source Documents for Scanning JDA 2-26
- Digitize & Attribute Tile Drains N/A
- Digitize & Attribute Storm Drains JDA 2-26
- Digitize & Attribute SSD JDA 2-26
- Digitize & Attribute Open Ditch N/A
- Stamp Plans JDA 2-26
- Sum drain lengths & Validate JDA 2-26
- Enter Improvements into Posse JDA 2-26
- Enter Drain Age into Posse July 4-23
- Sum drain length for Watershed in Posse July 4-23
- Check Database entries for errors JDA 2-26

**Gasb 34 Footages for Historical Cost  
Drain Length Log**

Drain-Improvement: PEBBLE BROOK DRAIN - PEBBLE BROOK - SECTION 7

Drain Type:	Size:	Length <small>SURVIVAL REPORT</small>	Length (DB Query)	Length Reconcile	If Applicable	
					Price:	Cost:
SSD	6"	520'	520'	∅	\$ 2.00	\$ 1040.00
RCP	12"	524'	524'	∅	7.25	3799.00

Sum: 1044'   1044'   ∅   \$ 4839.00

Final Report: \_\_\_\_\_

Comments:  
 \_\_\_\_\_  
 \_\_\_\_\_  
 \_\_\_\_\_  
 \_\_\_\_\_  
 \_\_\_\_\_  
 \_\_\_\_\_

CERTIFICATE OF COMPLETION AND COMPLIANCE

TO: HAMILTON COUNTY SURVEYOR

RE: **Pebble Brook - Section 3**

I hereby certify that:

- 1.) I am a Registered Land Surveyor in the State of Indiana,
- 2.) I am familiar with the plans and specifications for the above referenced subdivision,
- 3.) I have personally observed and supervised the completion of the Drainage Facilities for the above referenced subdivision, and
- 4.) To the best of my knowledge, information and belief, the Drainage Facilities within the subdivision has been installed and completed in conformity with all plans and specifications.

Signature:  Date: May 14, 1986

Type or Printed Name: John V. Schneider

Business Address: 3675 N. Post Road, Indianapolis, IN. 46226

Telephone: (317) 898-8282

INDIANA REGISTRATION NUMBER

S0115

SEAL

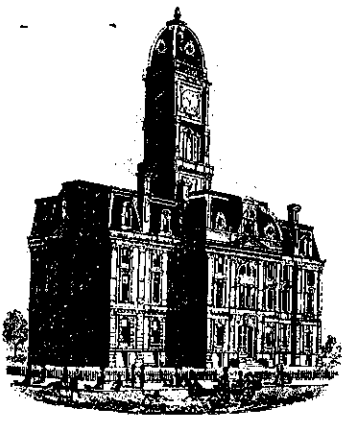

SURVEYOR'S OFFICE  
**Hamilton County**

*Kenton C. Ward, Surveyor*

773-6110 Ext. 19

*Noblesville, Ind. 46060* August 29 1988

To: Hamilton County Drainage Board

Re: Pebble Brook, Section 3

I have inspected the drainage facilities for the Pebble Brook, Section 3 Drain and have found them to be complete and acceptable. The project engineer has submitted the Certificate of Completion and Compliance and "as-built" drawings on reproducible mylar of the drainage system.

Changes made during the construction of this section concerned the facilities on lots 31 and 32. This pipe changed size and length. Upon developing as-builts and calculations of actual constructed facilities, it was found that the pipe between structures 136 and 137 was installed at a - 0.19% grade. However, the invert difference between either end is 0.05 feet and therefore negligible. The ditch along the rear of lots 32 and 33 was not installed and the existing ditch filled in. Also the pipe from Pebble Brook Drive (Str. 137 to Str. 138) was installed as a 12" RCP in lieu of a 15" RCP and outletted into the existing ditch on lots 31 and 32 instead of extended to a new ditch at the rear lot line. The pipe size does not create a problem in this case as shown on the calculations. It was agreed that the open ditch across lots 32 and 33 be undisturbed and the length of the pipe from the street remain as is. An additional drainage easement across these lots has been recorded. The open ditch across lots 30 - 33 is not part of the drain at this time.

Calculations show that during a 10 year storm event, water will stand in the cul-de-sac on Pebble Brook Place. In order to help alleviate this problem, a swale was cut between lots 45 and 46. An easement to cover this swale was recorded.

The plans by Schneider Engineering marked record drawing and dated 12/23/87, show the drain as constructed. The new lengths involved are as follows:

6" SSD - 520 feet                      12" RCP - 524 feet

The new total length of the drain is 1044 feet.

At this time I recommend the Board approve the drainage facilities as constructed. The non-enforcement request for this plat was approved by the Board with the final report of Section 1.

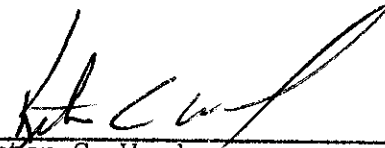
  
\_\_\_\_\_  
Kenton C. Ward,  
Hamilton County Surveyor

KCW/jh

**FILED**

SEP 12 1988

HAMILTON COUNTY DRAINAGE BOARD  
  
SECRETARY

# Legend

- sanitary sewer for exact information on sanitary sewers see plans by M.D. Wassler & Associates Inc.
  - storm sewer
    - std. stl. and soc. inlet w/ ditch grate
    - rip rap
    - subsurface drain (s.s.d.)
    - inlet w/ curb estg.
    - typical structure no.
  - water water to be installed by Harbor Water Co. (location may vary)
  - denotes building pad with minimum pad elevation
  - denotes no pad with minimum grade elevation at building
  - denotes minimum flood protection grade
- dimensions, bearings, & easements are shown for reference only and do not necessarily depict actual recorded information, see recorded plat for exact information

### LEGEND FOR RECORD DRAWING

- STORM SEWER IN PLACE
- EXIST. BEEHIVE INLET
- EXIST. MANHOLE
- EXIST. END SEC.
- 00.0 - SPOT ELEVATION OF RECORD
- PROPOSED STORM SEWER (NOT IN PLACE)
- PROPOSED SWALE (NOT IN PLACE)

NOTE: NO GRADE CHANGES OR TRENCHING WITHIN EASEMENT WITHOUT EASTERN PIPELINE CO. CALL 317-873-3382



This information was gathered for input into the Hamilton County Geographical Information System. This information is considered an official record of the GIS.

Entry Date: 2-26-04

Entered by: JDH

Pebble Brook Section

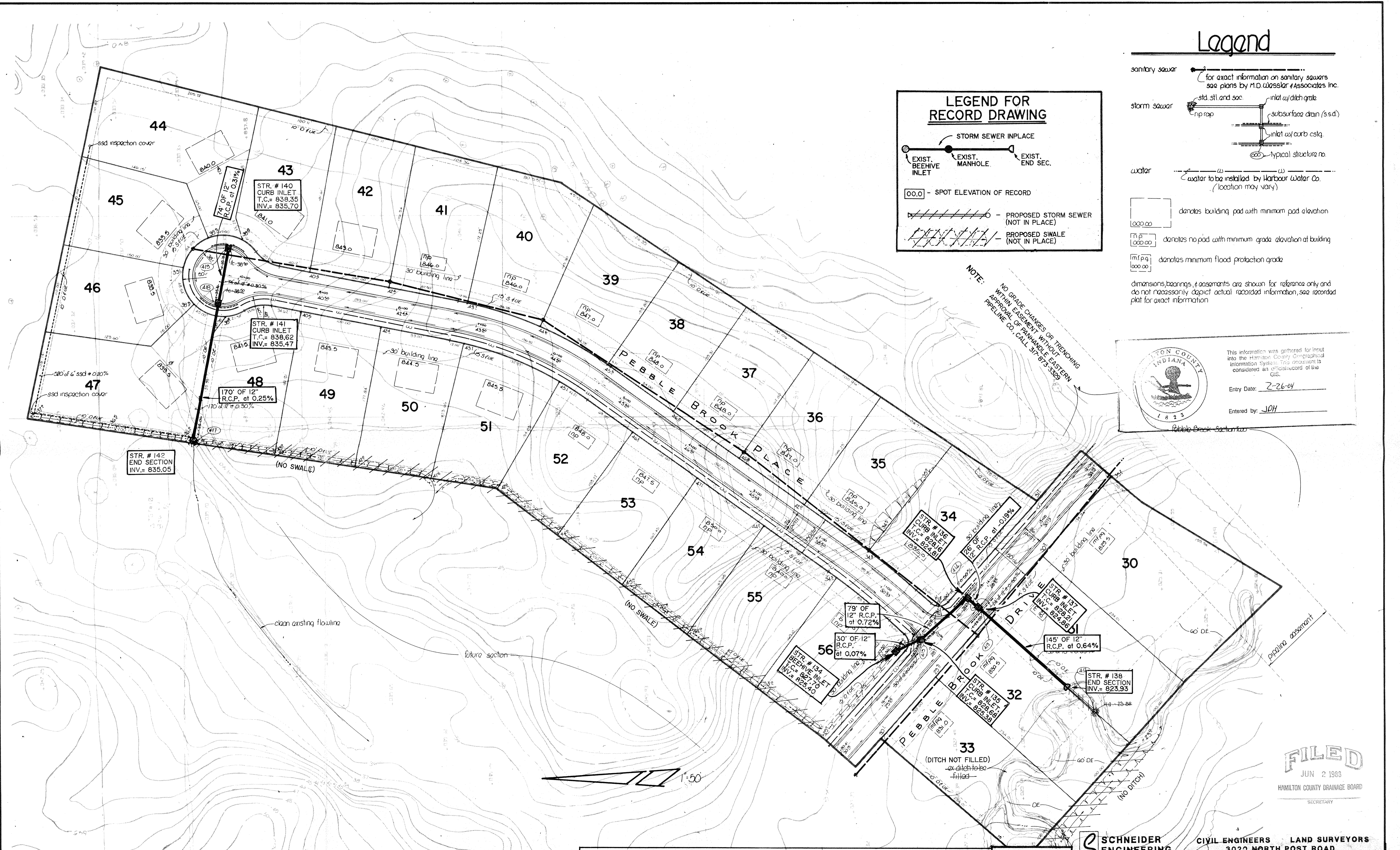

I hereby certify that the within Record (As-Built) Drawings were prepared under my direction as a result of field survey measurements made with regard to location, size, pipe invert elevation, and casting elevation of the storm sewer structures as indicated on the plans. Additionally, ground elevations were verified as indicated on the plans in specific swale, ditch, and storm water detention areas. The base sheets for these drawings are mylar reproducible of the initial construction plans provided by P. J. Cripe Inc. Surveyor's Office, One Hamilton Co. Square, Ste. 188, Noblesville, IN 46060

*John V. Schneider*

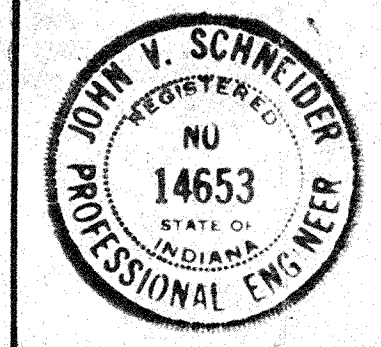

**SCHNEIDER ENGINEERING CORPORATION**  
 CIVIL ENGINEERS LAND SURVEYORS  
 3020 NORTH POST ROAD  
 INDIANAPOLIS, INDIANA 46226  
 TELEPHONE (317) 898-8282

**PEBBLE BROOK Sec. Three  
 STORM SEWER RECORD DRAWING  
 12/23/87**

SHEET R-8  
 of 9

**FILED**  
 JUN 2 1993  
 HAMILTON COUNTY DRAINAGE BOARD  
 SECRETARY

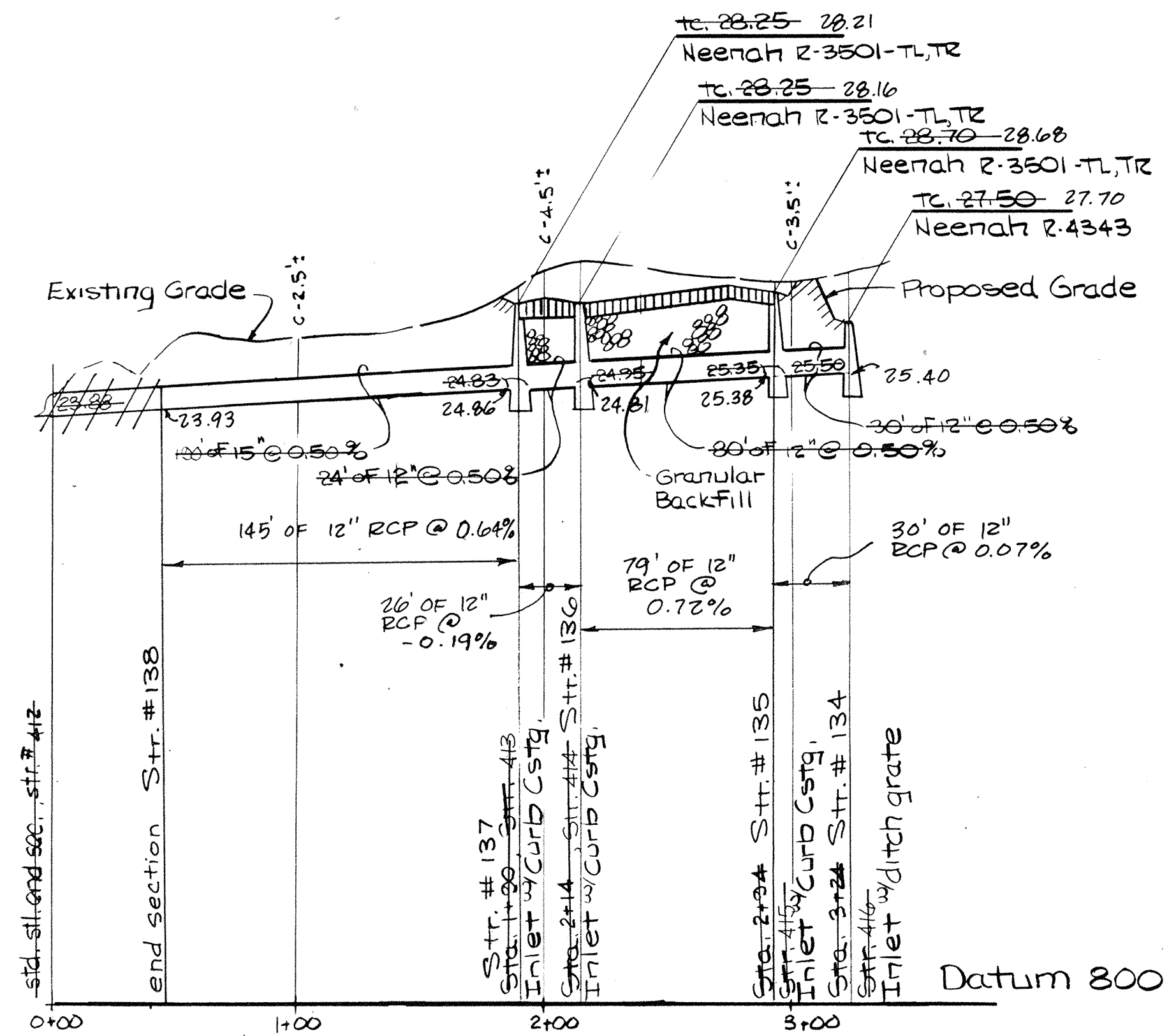

Profile One

Str. #  
Scale: 1" = 50' V  
1" = 50' H

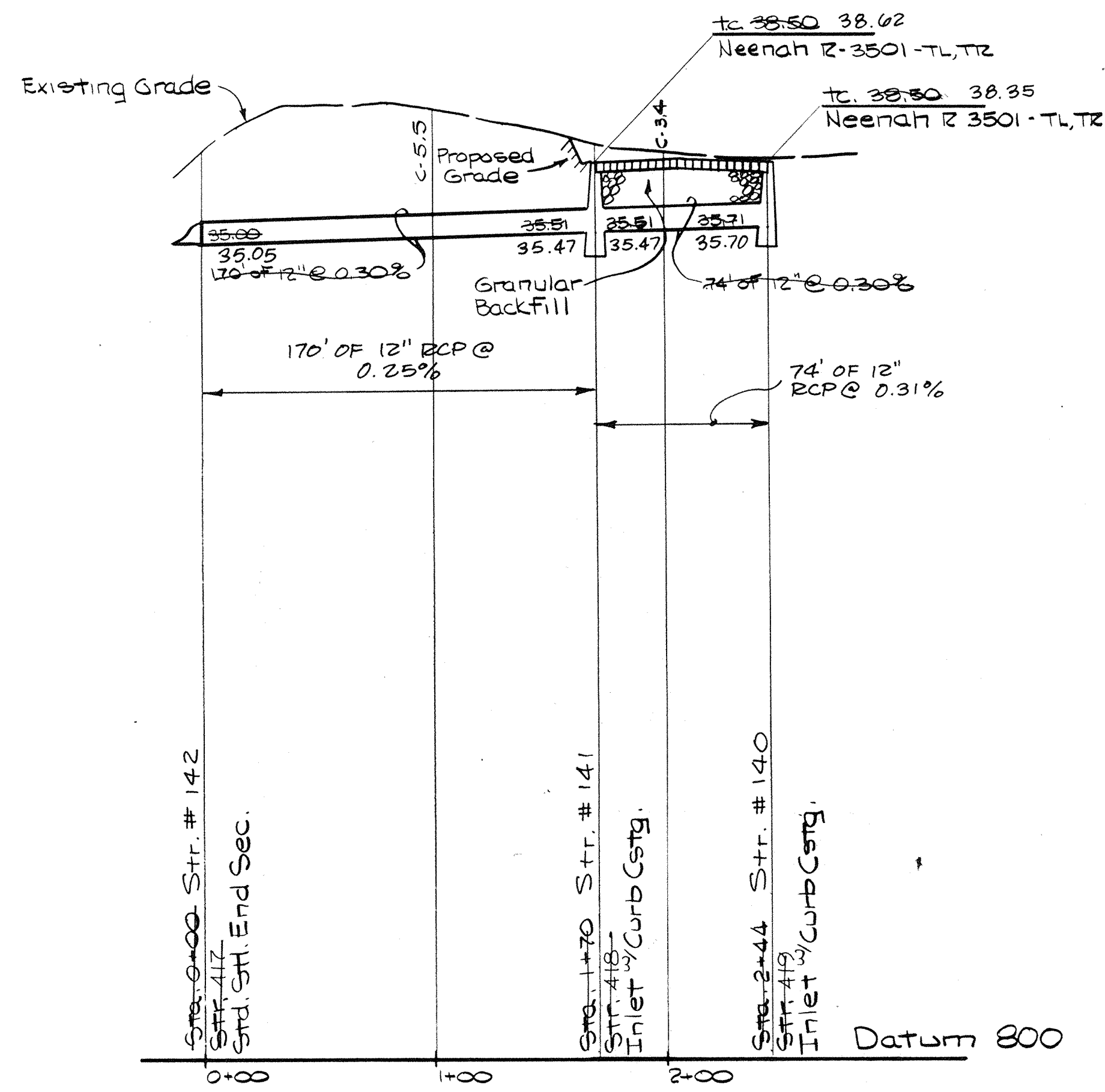

Profile Two

Str. #  
Scale: 1" = 50' V  
1" = 50' H

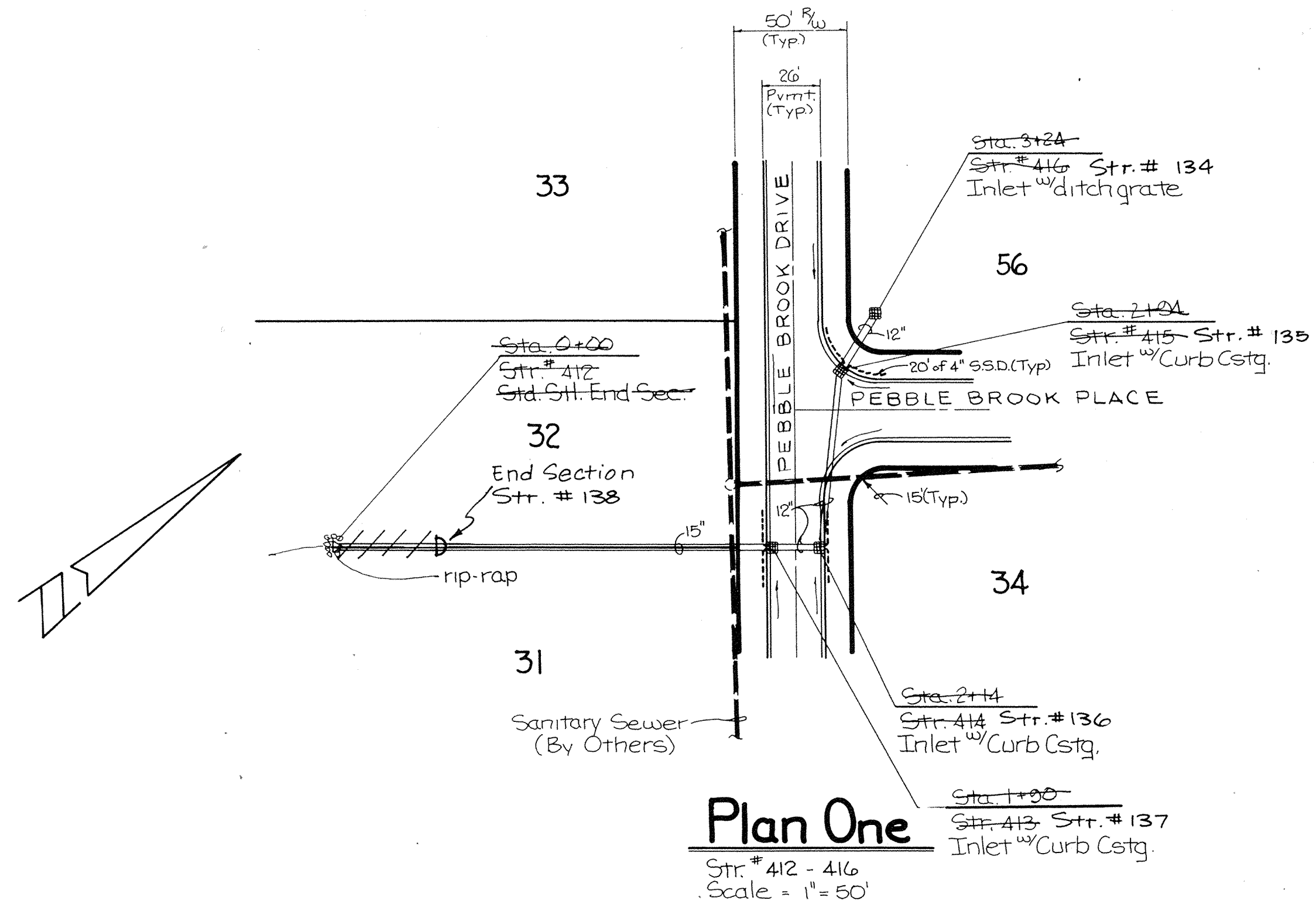

Plan One

Str. # 412 - 416  
Scale: 1" = 50'

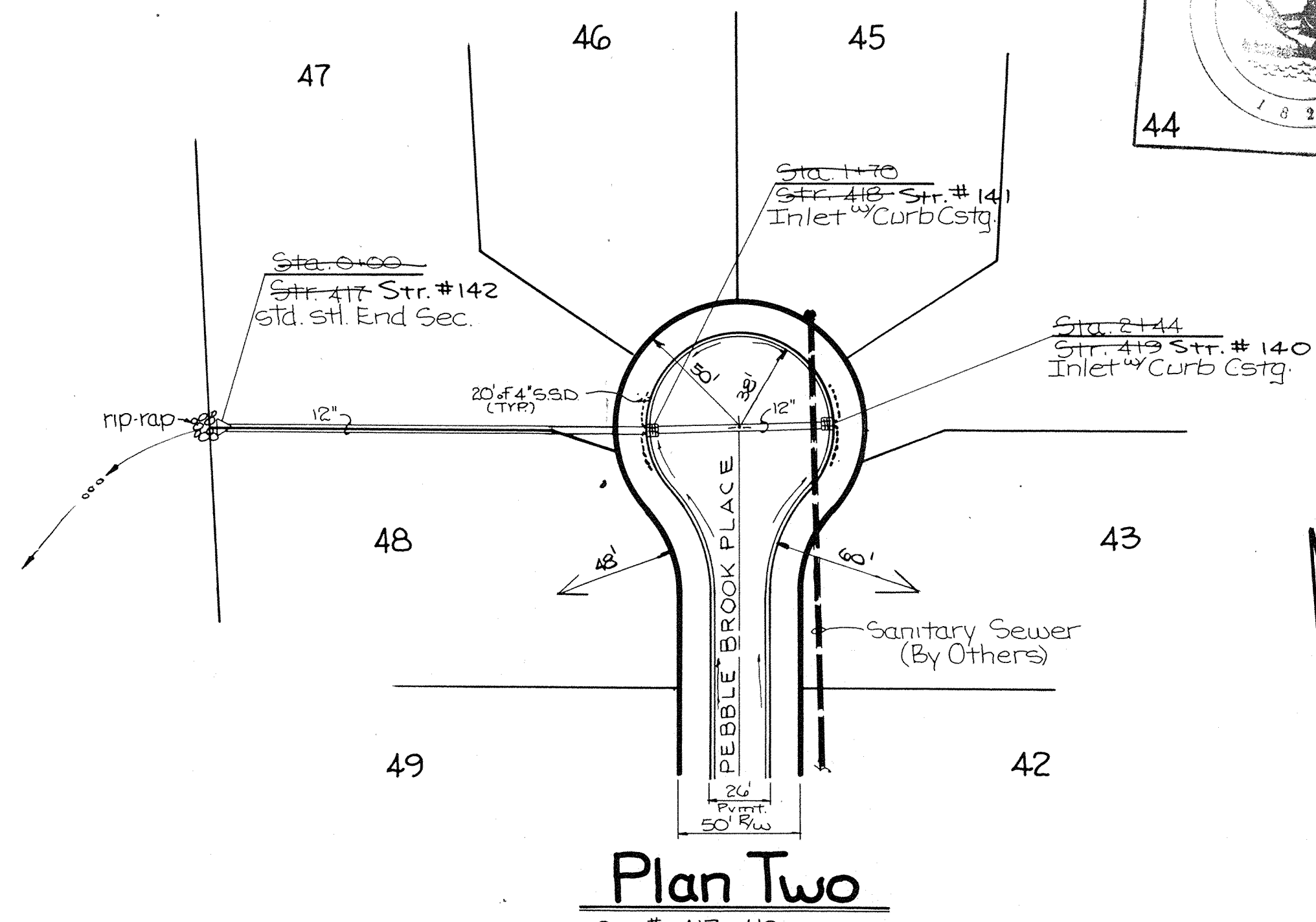

Plan Two

Str. # 417 - 419  
Scale: 1" = 50'

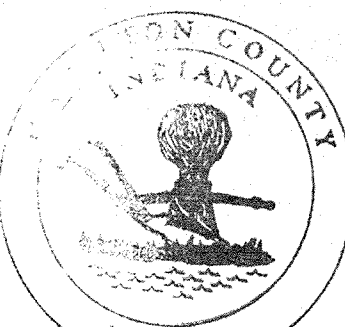
 This information was gathered for input into the Hamilton County Geographical Information System. This document is considered an official record of the GIS.  
 Entry Date: 2-26-04  
 Entered by: JDH

**FILED**  
 JUN 2 1988  
 HAMILTON COUNTY DRAINAGE BOARD  
 SECRETARY

I hereby certify that the within Record (As-Built) Drawings were prepared under my direction as a result of field survey measurements made with regard to location, size, pipe invert elevation, and casting elevation of the storm sewer structures as indicated on the plans. Additionally, ground elevations were verified as indicated on the plans in specific swale, ditch, and storm water detention areas. The base sheets for these drawings are similar reproduces of the initial construction plans provided by P. I. Cripe, Inc.

*John V. Schneider*

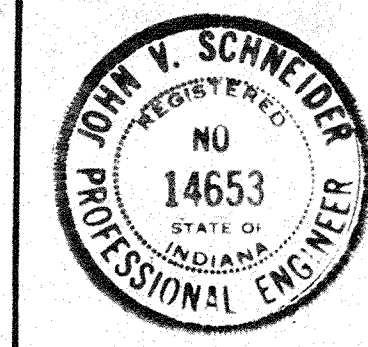

**SCHNEIDER ENGINEERING CORPORATION**  
 CIVIL ENGINEERS LAND SURVEYORS  
 3020 NORTH POST ROAD  
 INDIANAPOLIS, INDIANA 46226  
 TELEPHONE (317) 898-8282

**PEBBLE BROOK Sec. Three**  
**STORM SEWER RECORD DRAWING**  
 12/23/87

SHEET R.9  
 OF 9